

GXY-1L6 Load bearing wall on rear
Single entrance: 1200Wx1000D mm platform size

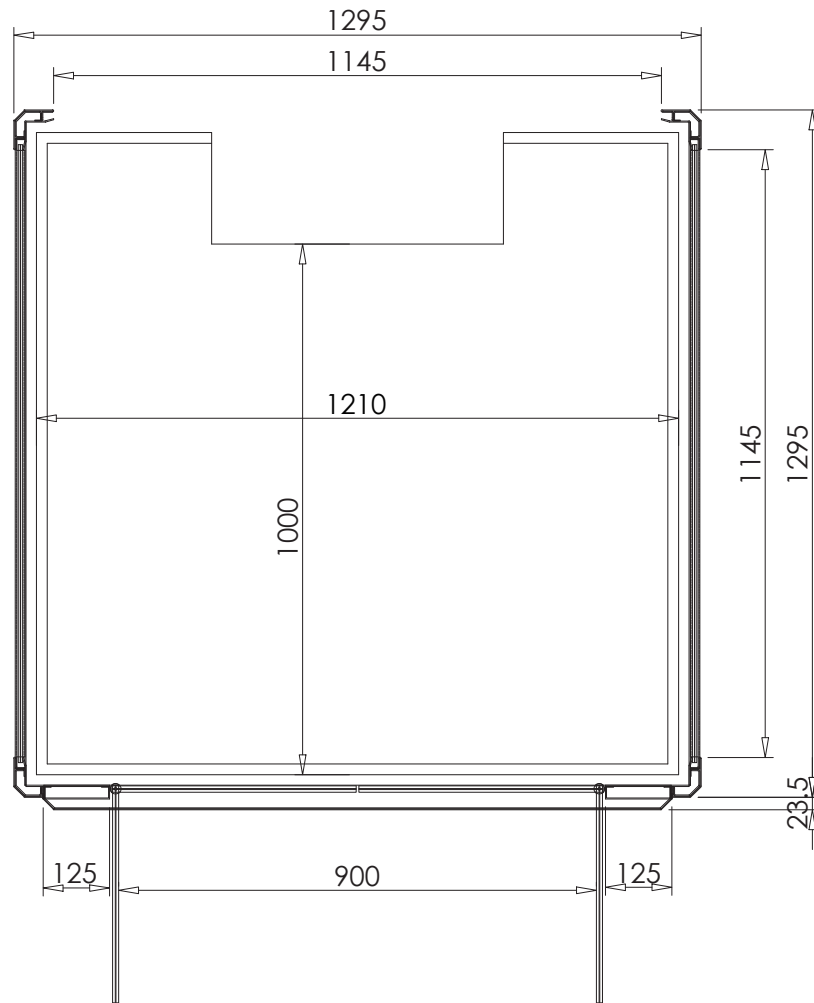

Note: Final measurements to be determined on final site specific drawings.



Explore
Galaxy Lift

100% European Quality Elevators
STATE OF THE ART SHOWROOMS AUSTRALIA WIDE

SPECIFICATIONS

Capacity	300kg
Speed	0.3m/sec
Pit Depth	50mm
Headroom	2350mm
Maximum Travel	12,000mm
Power	Single phase
Drive	Electric
Compliance	EN81-41

easy-living.com.au sales@easy-living.com.au

NSW & ACT: 8116 1500 VIC & TAS: 9094 8600

QLD & NT: 3851 7500 WA: 6272 9400 SA: 8231 8858

