

**GXY-1L4** Load bearing wall on rear  
**Single entrance: 1000Wx1000D mm platform size**

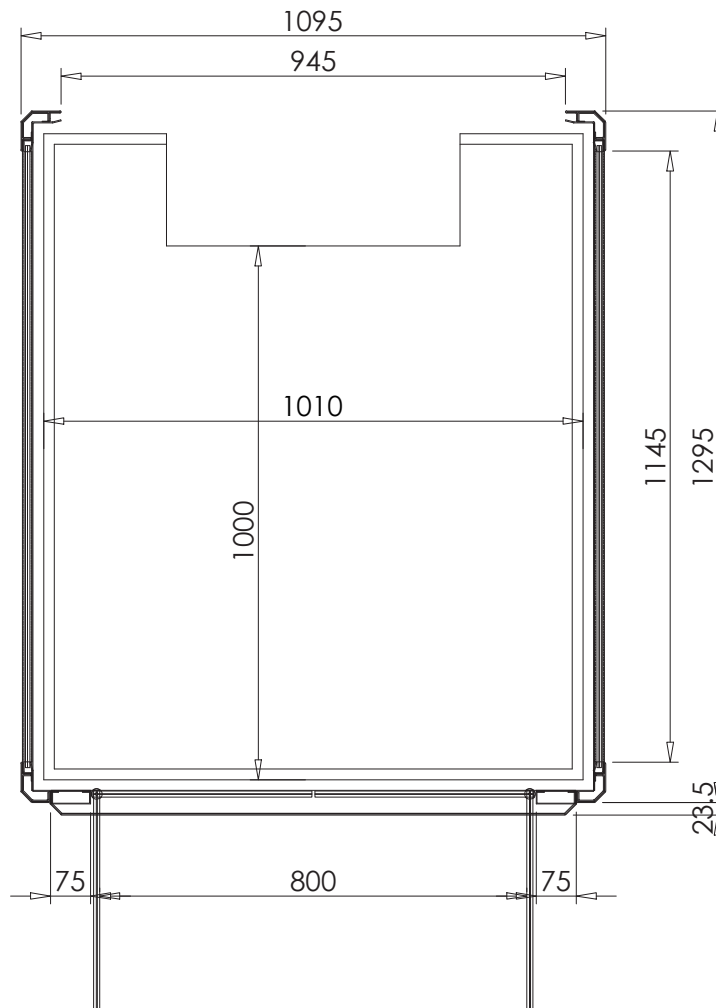

Note: Final measurements to be determined on final site specific drawings.



Explore  
Galaxy Lift

100% European Quality Elevators  
STATE OF THE ART SHOWROOMS AUSTRALIA WIDE

## SPECIFICATIONS

Capacity	300kg
Speed	0.3m/sec
Pit Depth	50mm
Headroom	2350mm
Maximum Travel	12,000mm
Power	Single phase
Drive	Electric
Compliance	EN81-41

easy-living.com.au sales@easy-living.com.au

NSW & ACT: 8116 1500 VIC & TAS: 9094 8600

QLD & NT: 3851 7500 WA: 6272 9400 SA: 8231 8858

